

**ROOF CAP SUPPORT ANGLE**  
 MK 353B12204 12 GA. x 4 1/4" x 2"  
 FULL SCALE

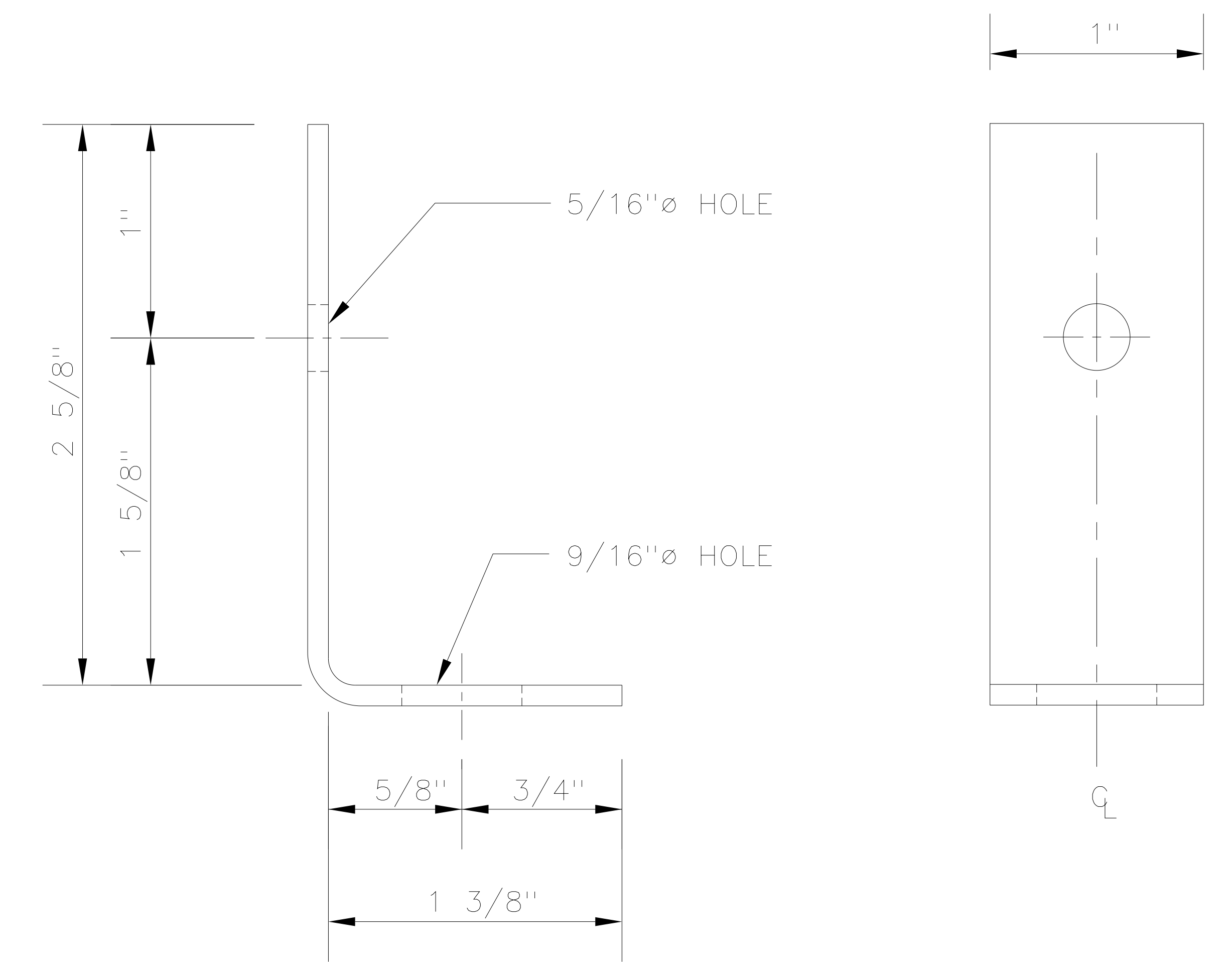

**SCREEN SUPPORT ANGLE**  
 MK 353B12104 12 GA. x 4" x 1"  
 FULL SCALE

\* USE 1/2" MESH FOR FACTORY MUTUAL APPROVED TANKS  
 MK 353G01376  
 (ALTERNATE 1/2" MESH)  
 CORROSION RESISTANT

\* SCREEN (1/2" MESH HARDWARE CLOTH)  
 76" LONG x 3 1/2" HIGH  
 MK 353G00376

ROOF CAP  
 MK 4GB26-1

3/8" x 1" LG. MECH. GALV. BOLT W/ NUT & 1" WASHER  
 3 REQ'D

ROOF CAP SUPPORT ANGLE  
 MK 353B12204  
 3 REQ'D EQUALLY SPACED

1/2" x 1" LG. MECH. GALV. SQ. HD. API TANK BOLT W/ H.D.G. NUT  
 9 REQ'D

1/4" x 1/2" LG. MECH. GALV. BOLT W/ NUT & FLAT WASHER  
 6 REQ'D

NOTE: BOLT SCREEN TO SCREEN SUPPORT ANGLE

SCREEN SUPPORT ANGLE  
 MK 353B12104  
 6 REQ'D EQUALLY SPACED

MANHOLE COLLAR

OVERALL HT. 11 1/2"

8"

27"

20" I.D.

22" B.C.

28- 30- 32- 36 HOLES DOWN (REFERENCE)

NOTE:

1. VENT PROVIDES 127 SQ. INCHES OF VENTING AREA.

**MANHOLE COLLAR W/ 20"Ø FREE FLOWING VENT**

28 HOLE DOWN	MK 353B00001
30 HOLE DOWN	MK 353B00002
36 HOLE DOWN	MK 353B00003
32 HOLE DOWN	MK 353B00004
30 HOLE DOWN	MK 353B00002FM (FACTORY MUTUAL)

△ CHANGED NOTE TO ELIMINATE 12" DISCHARGE	3/19/02	JC
△ CONVERTED TO AUTOCAD	10/26/98	JLP
△ 1/2" MESH HARDWARE CLOTH ECN 526	9/15/89	MSG
△ ADDED FACTORY MUTUAL P/N	1/5/87	JLA
△ ADDED PART NUMBER FOR 32 HL. DWN.	10/26/83	JLA
△ ADD PART NUMBER FOR 36 HL. DWN.	4/6/83	TBM
SYM	REVISION	ZONE DATE BY
SHOP DRAWING— MANHOLE COLLAR W/20"Ø FREE FLOWING VENT ASSY. FOR BOLTED TANK		D.T. NO. STD
DRAWN BY MAYHEW		MODEL NO.
CHECKED BY		SCALE 1/4" = 1"
APPROVED BY		DATE 1/6/83
CUSTOMER APPROVAL		NEXT ASSY.DWG. ITEM
		DWG. NO. 35303
5400 Kansas Ave. P.O. BOX 2907 Kansas City, Ks 66110		